

Proposed Project at Mouza-Santoshpur, J.L. No-22, Dag No-675, Khatian No-107, Premises No-294, Santoshpur Avenue, Ward No-103, Borough No-XI, under Kolkata Municipal Corporation, P.S.-Survey Park, Kolkata-700075

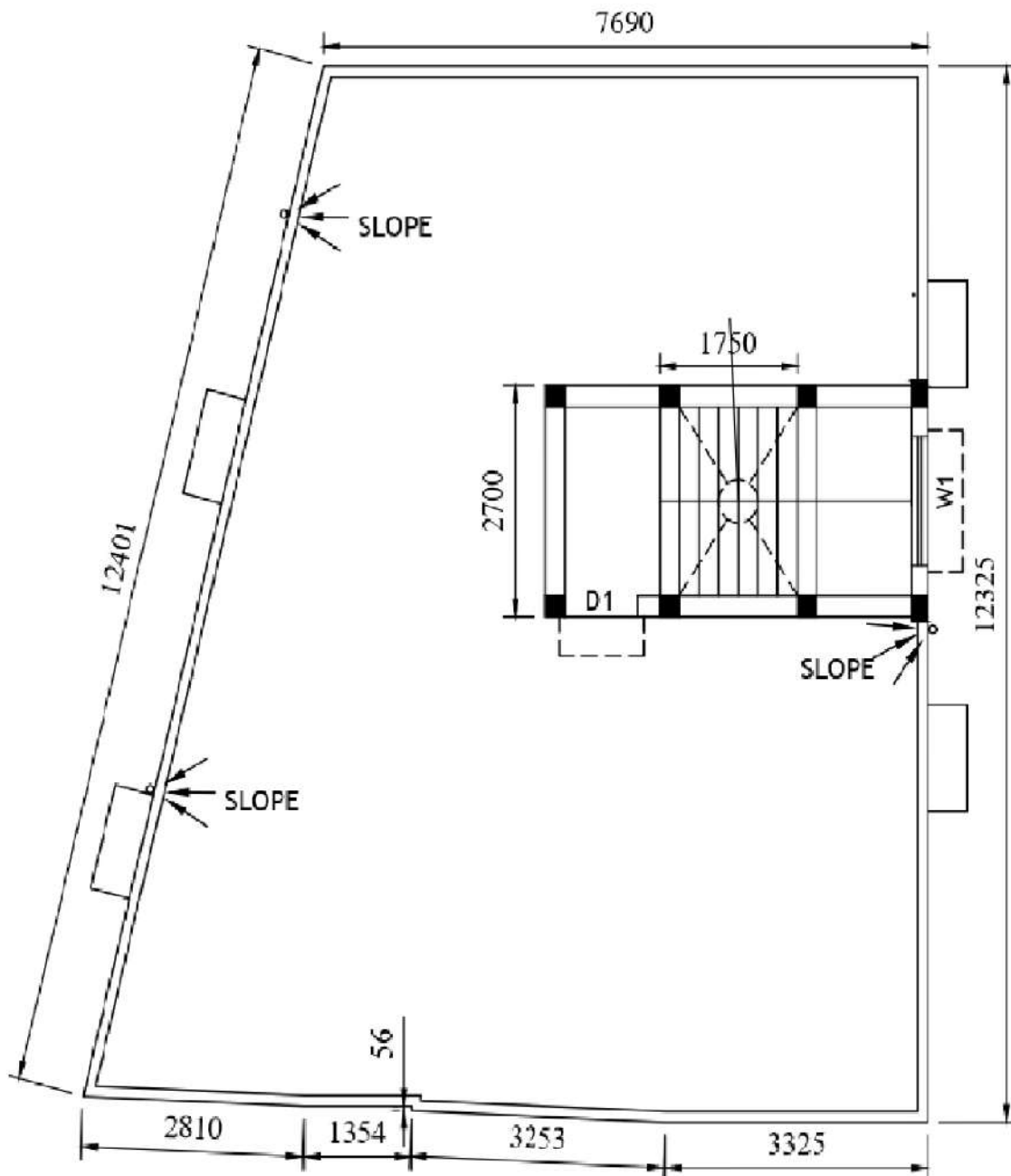

LATITUDE : 22.431265
LONGITUDE : 88.241207

R.K. Construction
Basu Das
Partner

SIGNATURE OF OWNER